

THE FIRE STATION
 Penthouse Apartment 7, fourth floor
Three bedrooms

- Kitchen**
- Kitchen cabinetry and hardware custom-designed and unique to the development
 - Quartzite natural stone worktop
 - Glazed terracotta backsplash
 - White ceramic under-mount sink
 - Designer single lever tap
 - Siemens dishwasher
 - Siemens fridge freezer
 - Miele induction hob
 - Miele Pureline microwave/oven combi
 - Miele Pureline single oven
 - Miele warming drawer
 - Wine cooler

- Bathrooms**
- Bathroom tiling: Calacatta Viola marble flooring and white matt ceramic wall tile laid in a herringbone pattern with tile skirting boards
 - Bathroom fittings: ceramic pedestal basin, antique gold basin tap, wall-mounted mirror cabinet with lighting, antique gold towel warmer, classic back-to-wall toilet and inset bath with antique gold shower and bath fixture

- Interior finishes**
- Engineered oak parquet flooring in a herringbone pattern to living, kitchen and dining areas
 - Engineered oak plank flooring laid in bedrooms, and hall
 - Custom-designed, integrated wardrobes to all bedrooms
 - Siemens washing machine and separate condenser dryer
 - Custom-designed ironmongery with brass rose and teak wood handle
 - Bioethanol Fireplace

- Master en-suite tiling: custom-designed marble flooring in a mosaic pattern and bespoke wall cladding
- Master en-suite fittings: ceramic basin on antique gold console, antique gold tap basin, bespoke mirror cabinet, antique gold towel warmer, classic back-to-wall toilet and free-standing bath with antique gold bath fixture
- Loft en-suite tiling: marble floors with brass trim and bespoke wall cladding
- Loft en-suite fittings: ceramic basin on antique gold console, antique gold basin tap, bespoke mirror cabinet, antique gold towel warmer, classic back-to-wall toilet and free-standing bath with antique gold bath fixture

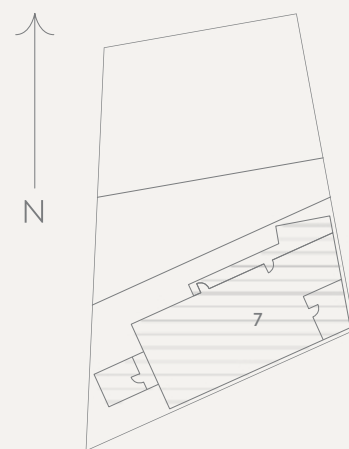

Internal area	159 sq m	1707 sq ft		
Fourth floor (bottom plan)			Fifth floor (top plan)	
Kitchen & dining area	9.8 x 3.6m	32.2 x 11.8ft	Bedroom three	6.0 x 3.3m 19.7 x 10.8ft
Living area	6.0 x 4.7 m	19.7 x 15.4ft		
Study	2.5 x 1.5 m	8.2 x 4.9ft		
Master bedroom	7.3 x 4.4 m	24.0 x 14.4ft		
Bedroom two	3.5 x 3.7 m	11.5 x 12.1ft		
Terrace one area	8.5 sq m	91.5 sq ft		
Terrace two area	20.8 sq m	223.9 sq ft		

Floor areas are approximate.
 Plans and specifications are for indicative purposes only.
 Dashed area indicate approximate skylight areas.